

特点

- 全扩散工艺，平板型陶瓷管封装
- 中心放大门极结构
- 双面冷却

典型应用

- 大功率变流器
- 交直流电机控制
- 交直流开关、相控整流
- 有源和无源逆变

最小 典型 最大



%

,

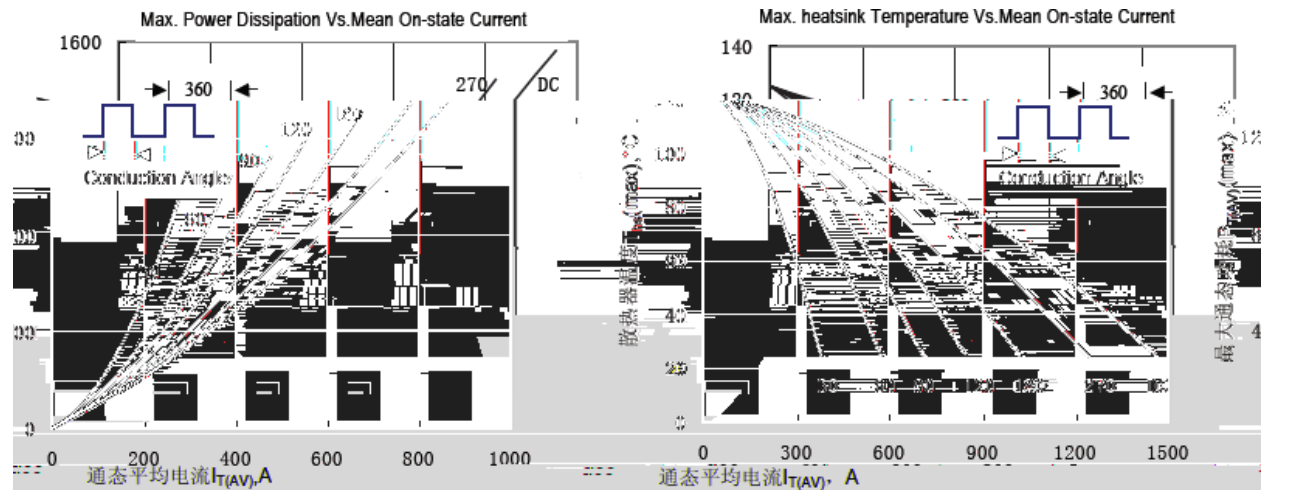
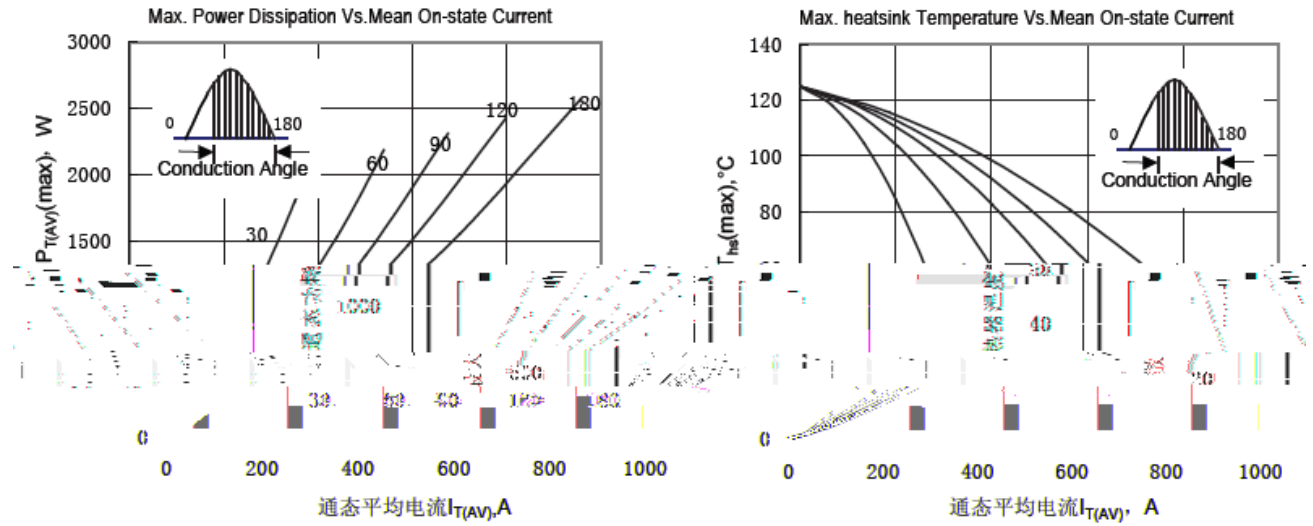
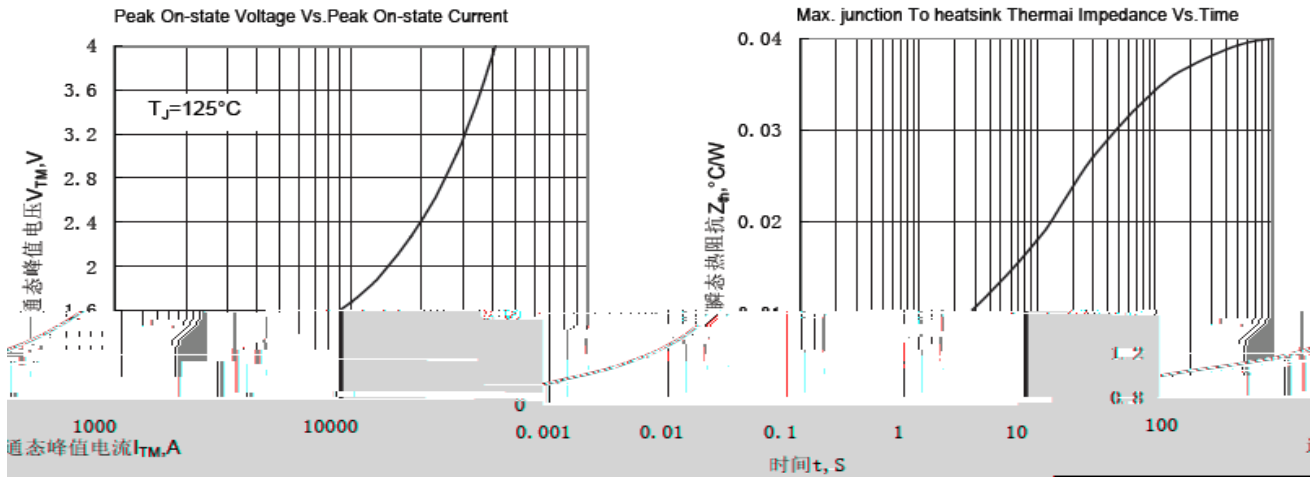

器温度与通态平均电流关系曲线

Fig.5 最大功耗与平均电流关系曲线

Fig.6 散热

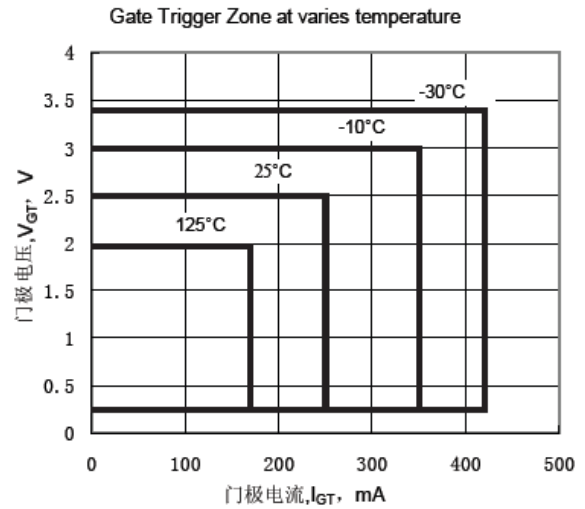
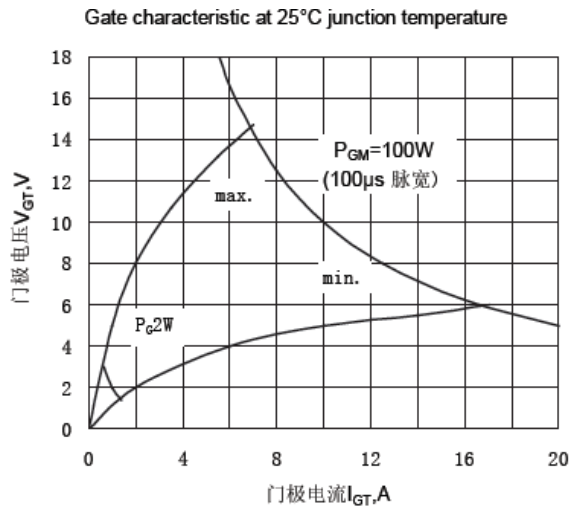
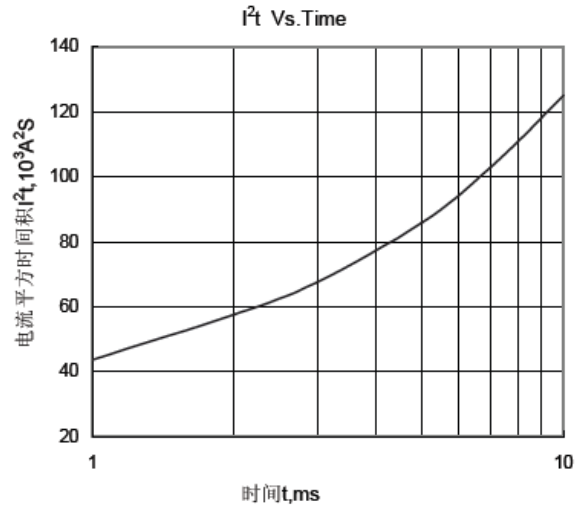
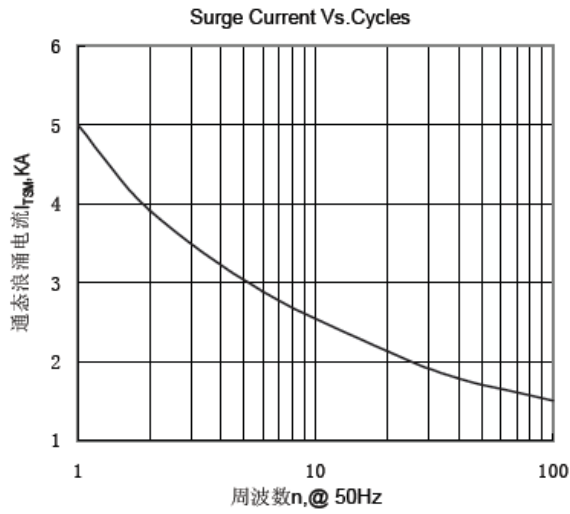

外形图:

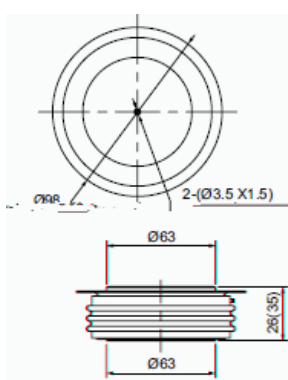

图

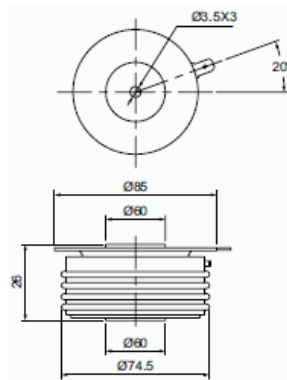

图

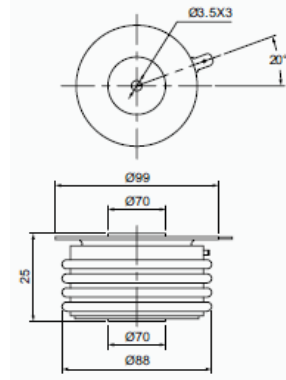

图

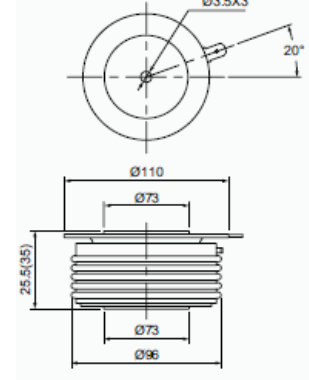

图